

LEADING THE WAY IN SUNDECKS AND DECKING ACCESSORIES

HOLIDAY HOMES • PARK HOMES • RESIDENTIAL

SUPPLYING QUALITY DECKING AND ACCESSORIES SINCE 1989



The Mayfield Group has been supplying decking systems (Sundecks) for homes across the UK for over 25 years. Today choosing and ordering your Sundeck from Mayfield could not be easier.

Every enquiry we receive is followed by a no obligation quotation offering you a no hidden extras price. When you have chosen your design and would like to proceed we can manage the installation on your behalf, including liaising with your park over installation dates.



QUALITY GUARANTEED

FULLY TESTED & CERTIFIED TO BS STANDARDS

Unlike many providers our products are not just built to an industry standard. They are built, fully tested and Certified to British Standards including BS5395 Stairs and Walkways code of practice and are UL94-VO Fire Rated.



LOW MAINTENANCE

Our Sundecks require the minimum of maintenance as they are made from high performance external grade materials.

WEATHER RESISTANT

British Standard BS EN607 10 year colourfast weather tested, our uPVC products will not warp, splinter or crack. Our C16 strength graded treated timber will not rot and will resist insect and fungal attack.

SLIP AND STAIN RESISTANT

Our Sundecks are British Standard BS7976-2 with textured and embossed surfaces to ensure slip resistance. The materials used to make our Sundecks are non-porous making them resistant to most food and beverage staining.

VERY DURABLE

Made using high impact modifiers the products used in the construction of our Sundecks have been tested to British Standard physical load test BS6399-Pt1.

LOW NOISE

Our decking planks are individually installed onto timber sub-frames using our unique decking clips. This prevents the planks rubbing together and squeaking, whilst also preventing the growth of algae between the planks.



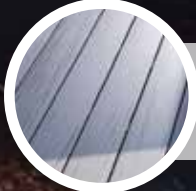

Dolphin Grey Hampton decking with Dark Brown vinyl wrapped rails.

PREMIUM SUNDECKS AND DECKING

HAMPTON RANGE

When choosing a Mayfield Sundeck, there are no limitations. We have a huge selection of styles, colours, finishes and accessories to choose from to complement all modern homes and our friendly, experienced Sundeck sales and design team are on hand to assist you every step of the way. When your Sundeck has been designed and ordered, we will keep you and your park updated with installation dates.

Prior to ordering your Sundeck you may want to consider the following; Does your holiday or park home require a Sundeck to incorporate a view which our ClearView range could enhance? Position of the sun, which will determine the design. Wind protection to eliminate drafts. Park specification. Your budget. Specific needs.

If you have any questions please call our team. Our years of experience means we can offer advice and ideas for your Sundeck and we will work closely with you to design and create your perfect outdoor living space that's right for you and your family's needs.

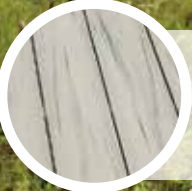

Cornish Cream Hampton decking with Colonial Cream rails, vinyl wrapped Slate Grey posts and Windsor lights. Extra wide steps.



Mixture of clear and frosted framed glass.

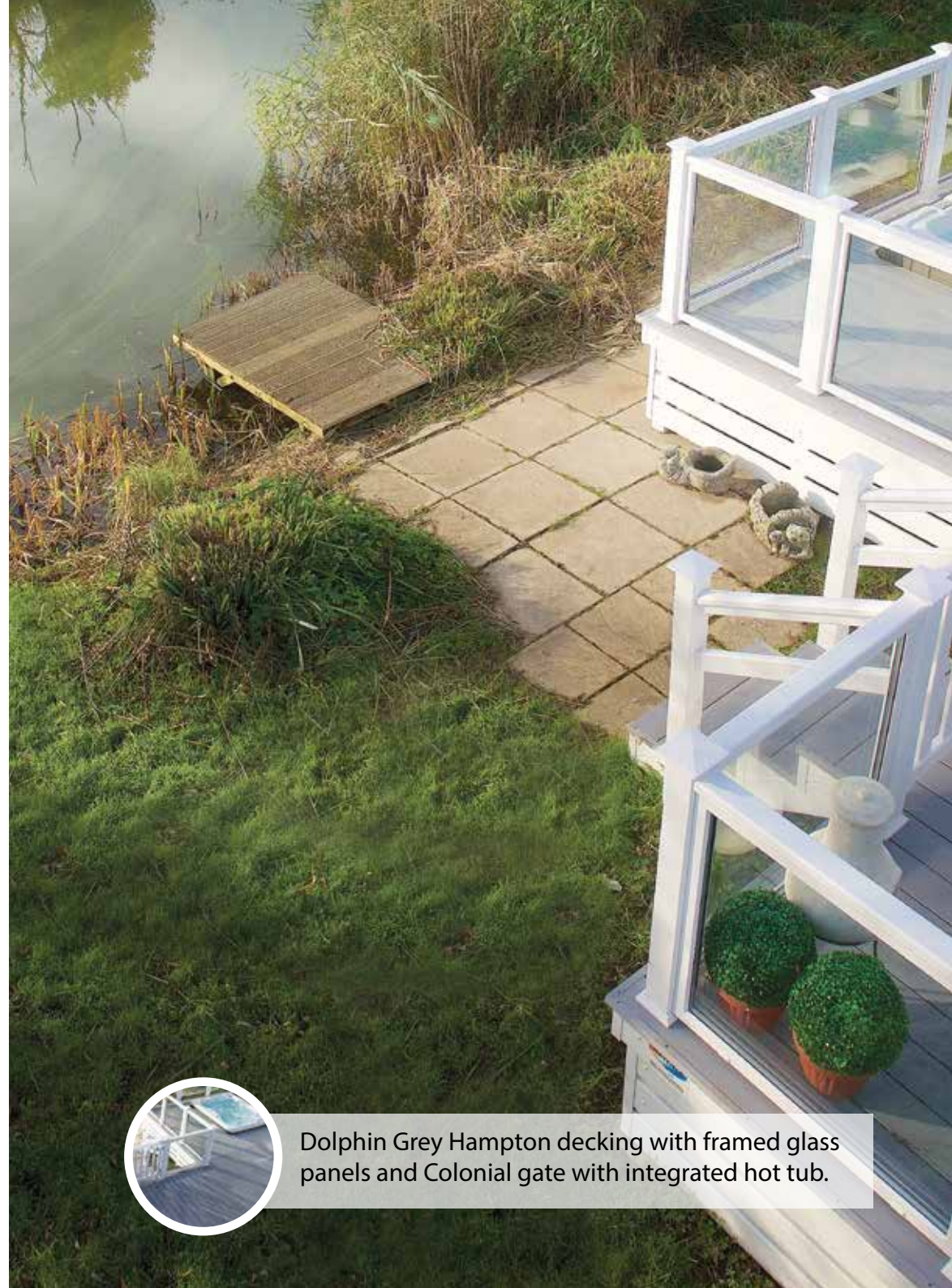

Dolphin Grey Hampton decking with framed glass panels and Colonial gate with integrated hot tub.



PREMIUM SUNDECKS AND DECKING

HAMPTON RANGE

The Hampton Range is our premium product and offers high quality Sundeck options that incorporate the very latest in decking technology including ClearView balustrades, multi-level Sundecks and bespoke step systems. The Hampton decking palette of colours consist of Coconut Brown, Cornish Cream, Dolphin Grey, Seamist Green, Brownsea and Kimmeridge Bay.

The Hampton Range is further enhanced with its unique integrated LED handrail which cleverly conceals a waterproof LED strip to the underside of the top handrail. This innovative design allows the LED strip lighting to be added during the installation of your Sundeck or retro fitted at a later date and is available in a range of colours to suit your individual taste.



Coconut Brown Hampton decking with frameless posts and Windsor lights. Post and rail skirting.

PREMIUM SUNDECKS AND DECKING

HAMPTON RANGE



✓ MODERN DESIGN

The most modern designs incorporating industry leading materials for long-term low maintenance.

✓ INTEGRATED LIGHTING

The only integrated LED handrail system available which looks sublime and is energy efficient.

✓ 12 YEAR MANUFACTURER'S WARRANTY

12 year colour fast warranty, tested beyond British Standard BS EN607.



OPTIONS

Our Hampton decking is available in the following colours



Dolphin Grey



Cornish Cream



Coconut Brown



Seamist Green



Brownsea Brown



Kimmeridge Bay Grey



Focus Decking boards with Colonial Cream rails and Silverback steps.

ESSENTIAL SUNDECKS AND DECKING

FOCUS RANGE

Our Focus range of Sundecks has been designed specifically for the cost conscious customer. The Focus range does not offer all the options that come as standard with the Hampton range but still offers a high quality product with a key feature being the wider decking boards, which at 235mm looks and feels robust and manufactured in a new and very eye catching Driftwood colour.

The Focus Sundeck range has been weather tested to ensure long-term, low-maintenance and has a 3 year manufacturer's warranty. Ask your nearest Mayfield approved installer for further information.

Detailed features of the Hampton and Focus range of decking can be found on page 21.

- ✓ **3 YEAR MANUFACTURER'S WARRANTY**
10 year colour fast warranty tested to British Standard BS EN607.



- ✓ **HIGH QUALITY SUNDECKS**
Manufactured from long term ultra-low maintenance materials.

OPTIONS

Our Focus decking is available in the following colour.



Driftwood



Colonial Balustrades

Focus Decking is only available with Standard Colonial Balustrades in Cream or White

uPVC BALUSTRADE FINISHES



The Hampton Range comes in a choice of 3 balustrade styles and 5 colour options, with the LED top handrail as standard (LED light strip additional accessory). The Focus range is available in 1 balustrade style and 2 colour options. All our balustrades have been designed to fit seamlessly with your choice of decking and structurally engineered to British Standard BS6180. Our balustrades are installed using fewer newel posts offering a more contemporary design without sacrificing strength.

The brackets used on our balustrades feature concealed fixings and external radiuses. Each newel post comes with a Windsor collar and with the Hampton range, a matching Windsor post cap to give a beautiful uniform finish. All of which are unique features to Mayfield.

- Completely waterproof so no mould or decay
- Easy to clean and stain resistant
- Choice of colours
- No visible fixings
- External radius brackets
- British Standard BS6180

OPTIONS

All our balustrade options include LED top rail. LED lights sold separately. Three balustrade options are available with Hampton Decking.



CLEARVIEW RANGE OF BALUSTRADES



If your holiday or park home has a fabulous view, why not make the most of it with our ClearView balustrades. ClearView glass panels have many advantages over traditional picket designed balustrades and are one of the most popular upgrades for our customers who like their scenery uninterrupted.

ClearView is available in framed and frameless designs with clear, tinted, obscured and sandblasted options, providing protection against the wind and adding a touch of opulence.

✓ FRAMELESS

Stainless steel glass clamps mounted onto posts
Supplied with 10mm toughened glass as standard

Frameless Options:

Ultra S/S Glass Clamps
Tints: Clear/Bronze/Smoke/Blue
Additional toughened and laminated sizes
Sandblasted options including park logos/designs



✓ FRAMED

Double glazed units with handrail mounted on top
Superb wind protection, obscured and sandblasted

Framed Options:

White/Golden Oak/Slate
Tints: Clear/Bronze/Smoke/Blue



LIGHTING OPTIONS



By adding one of our amazing lighting options the enjoyment of your Sundeck doesn't need to stop when the sun goes down.

When considering lighting ask our sales team for the options available, and be inspired to add a glow to your deck. Lighting makes all the difference when entertaining or using your deck in the evenings, as well as looking amazing. Good lighting is about complementing your Sundeck and the correct lighting will enhance features such as balustrades, hot tubs and dining areas.

With our complete range of Sundecks we offer the Windsor light – a simple and contemporary accessory designed to give a modern touch and creative lighting to any deck, it can be fitted to any post and is offered in a range of colours to suit and work with your choice of rail. Supplied and fitted with low-energy bulbs the Windsor light is both affordable and attractive.

✓ WINDSOR LIGHT

Colours: White/Cream/Golden Oak/Green/Slate
Low energy bulbs



✓ ENERGY EFFICIENT

Mayfield LED lighting not only looks good but is energy efficient, waterproof, robust and even comes backed with a 7 year warranty



Please note: Mayfield decking installers are not qualified electricians and therefore do not connect the lights. This must be done by a park approved electrician and could incur additional costs. Please speak to your park operator for more information on this.

LED INTEGRATED LIGHTING

Our integrated LED handrail lighting is revolutionary and offers the ultimate in outdoor lighting. Cleverly concealed in our handrail, once lit the LED strip lighting will transform your Sundeck into a glamorous almost magical look. The LED strip we supply is the best money can buy and boasts great features such as being energy efficient, waterproof, robust and even comes backed with a 7 year warranty. If you want an amazing lighting product which will enhance your Sundeck and have the 'wow' factor the LED handrail lighting is the one for you.



✓ CLEVERLY CONCEALED

Our LED handrail lighting is cleverly concealed in the handrail, once lit the lighting will transform your Sundeck. Comes with remote control with multi colour options.



SKIRTING

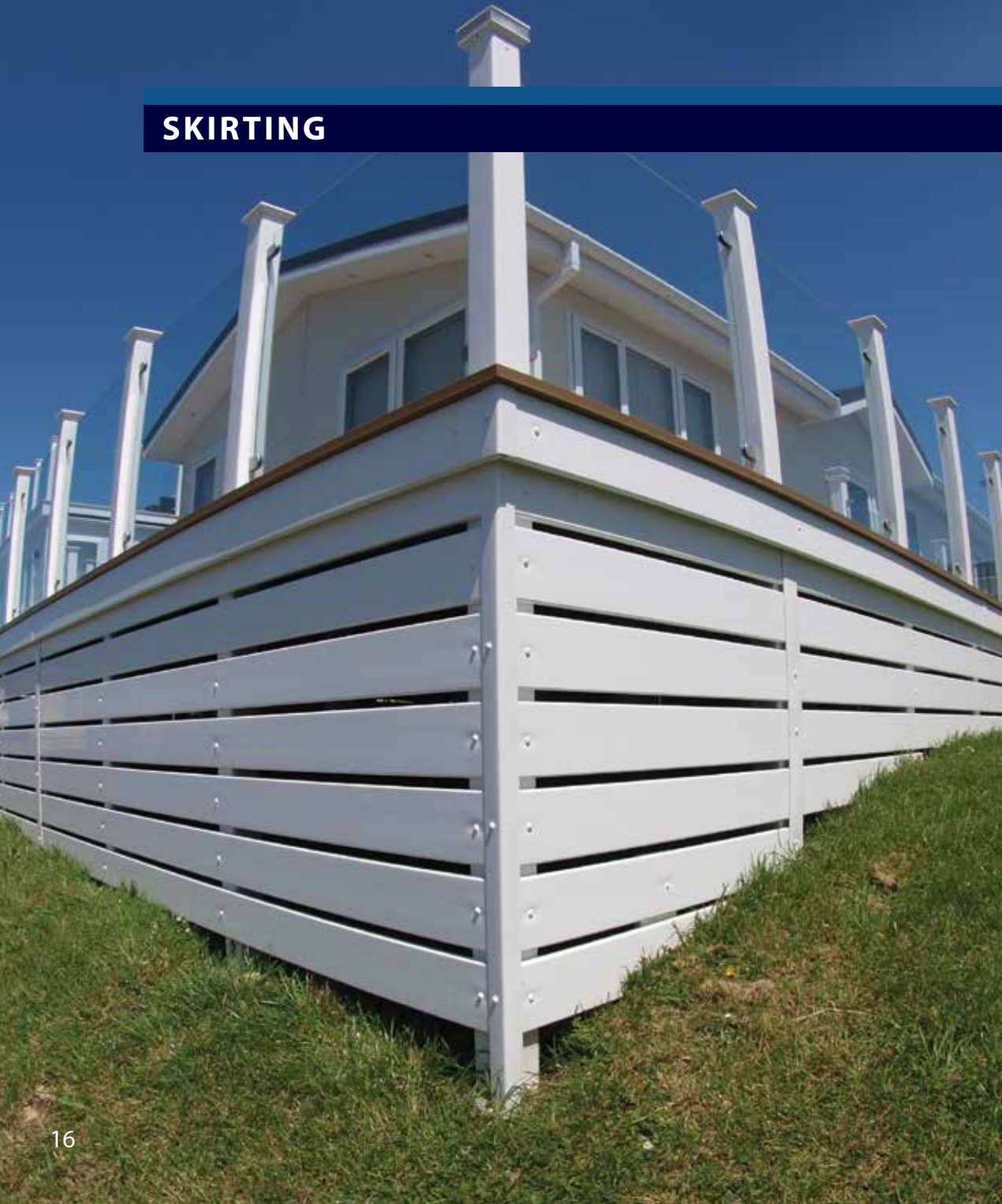

Having skirting installed to your home and Sundeck adds more than cosmetic finishing touches. Available in fully enclosed or ranch style the benefits of having skirting include:

- Helps to prevent heat loss
- Reduces draughts under your home
- Virtually maintenance free
- Enhances the visual appearance
- Reduces the risk of water pipes freezing
- Prevents unwelcome visitors getting under your home
- Large range of colours available to complement your home
- Adds value and style

FULLY ENCLOSED

Available in matching colour palette to complement your holiday or park home. Fully enclosed skirting provides protection from wind and cold and stops debris and small animals getting under the home. Our simple track system allows a single panel to be removed for easy access.



RANCH SKIRTING

Available in White and Cream or in vinyl wrapped Dark Green, Dark Brown, Golden Oak or Slate Grey supplied with two access gates as standard (more are available on request). Fitted by our team of professional installers to ensure a perfect finish to any home.



SKIRTING GATE

A must with Ranch Style Skirting these gates allow quick and easy maintenance access, fitted with our own top quality fixings to ensure no rust or corrosion. Two gates are fitted as standard with every skirting order and more are available on request.





GATES AND ACCESSORIES

GATES

Mayfield Sundeck gates are made using Masterjoints fixings, which are stronger and better by design than welded equivalents. All our gates are fitted using Masterjoint hinges and latches which will not rust, are extremely robust and carry a lifetime warranty.



STEPS AND ACCESS RAMPS

For easy access we can supply freestanding standard steps or low-rise steps if preferred. Our Sundeck steps are all designed to perfectly complement the colour and style of each deck.

All our access ramps are designed to DDA specifications and are easily incorporated into one of our decks to allow space and easy access to those who need assistance. All are made using the same materials for perfect colour matching.



RAIL SUPPORTS

All our Sundeck bottom rails are supported by footblocks to prevent the rail from sagging under load. They are structurally designed and in-keeping with the same design as our popular Windsor caps and collars to perfectly match your balustrade.

DESIGN YOUR OWN SUNDECK

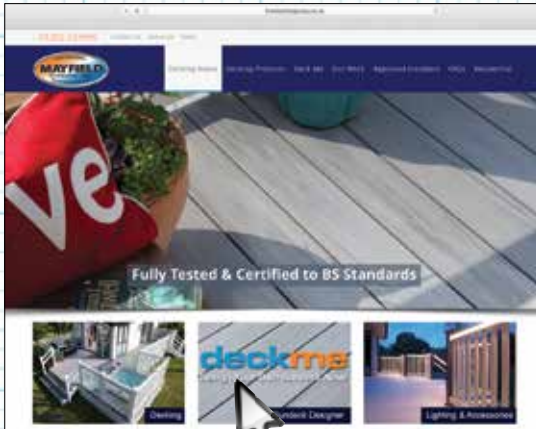

1 Simply visit www.themayfieldgroup.co.uk and click on deckme.

deckme.co.uk

For a quotation simply choose your preferred design from our twenty most popular Sundeck designs opposite and call the team. Alternatively our online Sundeck Designer tool has more features than ever before, you can even add skirting and ClearView glass balustrades. Design your layout and when you are happy, click 'submit design for quote' and our team will review your requirements sending you a quotation shortly afterwards. Holiday and park homeowners, caravan park sales and our dealers nationwide use our Sundeck Designer tool. Apart from being simple to use, it's fun and easy so don't be afraid and lets see your designs!

Designed by you... installed by Mayfield at www.themayfieldgroup.co.uk

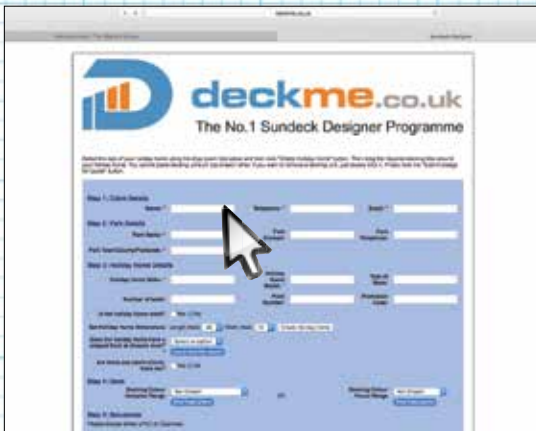

2 Fill in your details, size and model of your home.

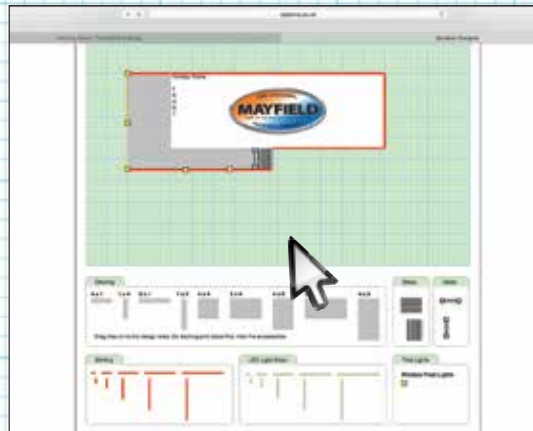

3 Drag and drop your designs around the plan of your home.



4 Simply click 'Submit Design for Quote'

STANDARD SUNDECK RANGE

Variable balustrade heights available on all our Sundecks

PS1 4' x 4'

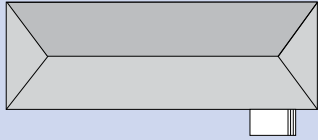

PS2 8' x 4'

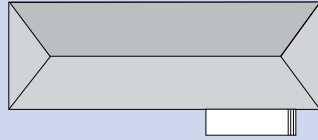

SD1 12' x 4'

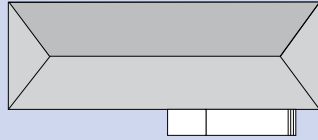

SD2 24' x 4'

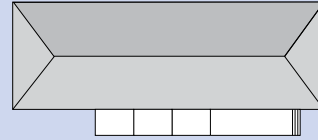

SD3 32' x 4'

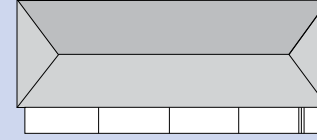

SD4 12' x 8'

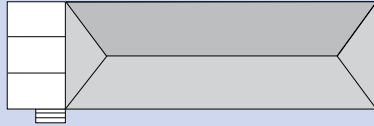

SD5 16' x 8'

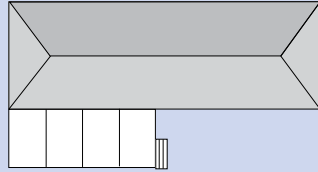

SD6 20' x 8'

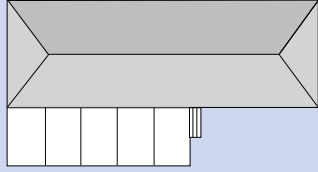

SD7 24' x 8'

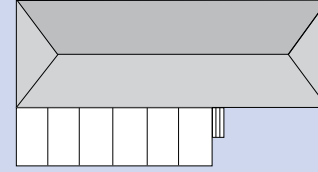

SD8 32' x 8'

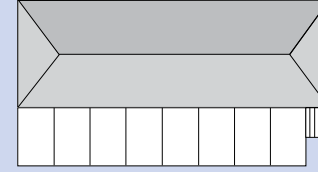

SD9 12' x 8' with 12' x 4' walkway

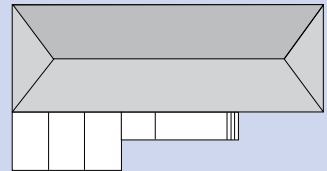

SD10 12' x 8' with 16' x 4' walkway

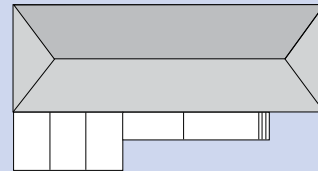

SD11 16' x 8' with 12' x 4' walkway

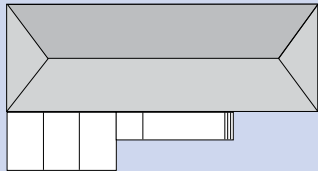

SD12 16' x 8' with 12' x 4' return



SD13 16' x 8' with 16' x 4' walkway

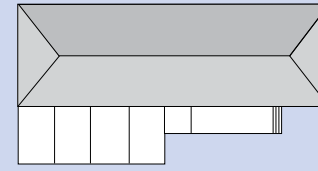

SD14 16' x 8' with 16' x 4' return

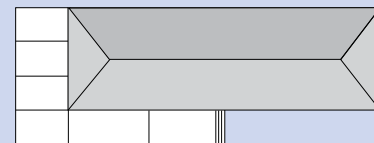

SD15 16' x 8' with 20' x 4' return

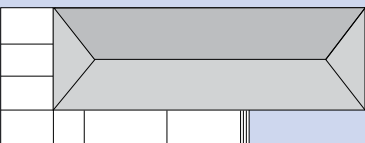

SD16 16' x 8' with 24' x 4' return

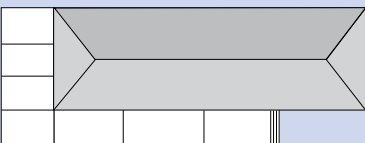

SD17 16' x 8' with 32' x 4' return

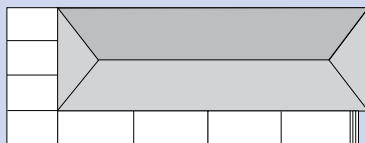

SD18 20' x 8' with 20' x 8' return

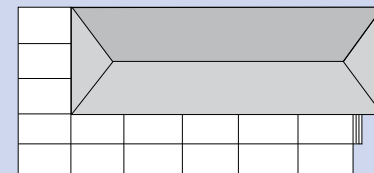

HOT TUBS



The perfect addition to your Sundeck to enjoy outdoor living to the maximum! We have the largest range of hot tubs in the UK to choose from at the most competitive prices.

- Single or Multi Coloured LED Lighting
- Top Rail Lighting
- Lit Volcano
- Stainless Steel Jets
- Dedicated Neck, Leg and Foot Jets
- Lit Pillowfall
- Stereo CD/FM Tuner/MP3 Jack
- Ozone friendly
- ArticPac Insulation
- Delux Spa Covers
- Maintenance Free Permawood Cabinet



MAINTAINING YOUR SUNDECK



Maintaining your Sundeck with the correct cleaning products will keep your Sundeck in tip top condition and will ensure your warranty is maintained. Mayfield cleaners have been specifically formulated to give the best results and are environmentally friendly. Available from our approved installers or online shop which can be found on our website. www.themayfieldgroup.co.uk

Sundeck Wash: Used as a general purpose wash; removes dirt, grime and grease stains. This unique formula is safe to use on all types of plastic, it is biodegradable, solvent free and leaves no white residue. A must for any Sundeck.

Waterless PVC Cleaner & Polish: Designed to keep your PVC balustrade looking clean and shiny without the need of water. Simple to apply and leaves a protective coating which will prolong the life of your balustrade. Mayfield recommended.

CHOOSING THE RIGHT DECK FOR YOU

	HAMPTON	FOCUS
100 x 50 Timber Subframes		●
150 x 50 Timber Subframes	●	
Hampton Decking	●	
Focus Decking		●
Full Length Timber Reinforcing in Posts	●	
LED Compatible Top Handrail	●	
Windsor Post Cap	●	
Windsor Collar	●	●
Flat Post Cap		●
Colonial Balustrade Option	●	●
Hampton Balustrade Option	●	
Victorian Balustrade Option	●	
ClearView Glass Options	●	
Optional Handrail Heights	●	
Mayfield Slabs	●	
Custom Sundeck Design	●	
12 Year Colourfast Warranty	●	
10 Year Colourfast Warranty		●



"Having the deck put down has been like building an extension to the house at a tiny fraction of the cost, we love the extra space! Also with 2 little ones, letting them come in and out without having to go up or down a step is completely worry-free, they love it, should have done it years ago!"

Tiphaine McConnell

HAMPTON RESIDENTIAL DECKING

RESIDENTIAL

Our brand new Hampton Decking is designed, manufactured and fitted by experts to enhance your outside space with minimal maintenance required.

Choose Hampton Decking to optimise your external space or to replace an existing decked area then sit back and enjoy!

- Suitable For All Size Deck Areas
- No Annual Treatments Required
- Wood Free, No Warping, Twisting, Shrinkage or Splinters
- Weather Resistant
- Slip and Stain Resistant
- 10 Year Colour Fast Warranty
- Built to British Standards
- Choice of Colours
- Optional Step, Balustrades and Lighting Systems Available

OPTIONS

Our Hampton Residential Decking is available in the following colours



Dolphin Grey



Cornish Cream



Coconut Brown



Seamist Green



Brownsea Brown



Kimmeridge Bay Grey

For further information on our residential decking range please call 01202 722722



www.themayfieldgroup.co.uk

The Mayfield Group Ltd
Chalwyn Industrial Estate
St Clements Rd Poole
Dorset BH12 4PE

01202 233959

email: sales@themayfieldgroup.co.uk



MANUFACTURED IN THE UK



APPROVED INSTALLER

For a complete list of UK installers visit www.themayfieldgroup.co.uk